



Range of epoxy painted steel stackers with frame equipped with variable geometry (patented). Available with a capacity of 300 or 600 kg and in manual (manual lift and travel), semi-electric (electric lift and manual travel) and motorised (electric lift and motorised travel) versions.

Performance

- Robust construction suitable for intensive use.
- Can be equipped with a variable geometry attachment allowing it to adapt to loads of different types and sizes.
- Manual model: 2 foot lift speeds, 40 or 70 mm/pump.
- Electric model: lifting speed from 110 to 180 mm/s depending on the model (programmable lifting speed depending on the model). Autonomy from 10 to 25 h with 10 cycles/h for a 600 kg load.

Versatility

- Kit for quick accessory change depending on the model.

Security

- Variable geometry allowing the spars to be spaced apart for better stability.
- Rear wheels equipped with foot protection and brake.
- Device to prevent the stacker from tipping over in the event of an obstacle on the descent path.
- Complies with the Machine Directive 2006/42/EC and ISO 3691-5.

Maintenance and warranty

- Guaranteed for 2, 3 or 10 years depending on the model, excluding parts subject to wear and tear.
- Maintenance contract on request: service provided by our teams. Subscription possible for new or existing Manuvit equipment.

Moreover, as nothing should justify throwing away a product under the pretext that it is damaged, we are able to put back in use all the materials of our manufacture and this, without limit of duration.

Complies with the Machinery Directive 2006/42/EC.



Lev300 manual / Equipped with 2 position plate accessory



Lev600 semi-electric / Equipped with the Rotofût accessory



Lev600 motorised / Equipped with Roto-coil accessory

Explanations of variable geometry



- The frame swings out to accommodate the load to be handled.
- Useful spacing of the longitudinal members :
Lev 300: from 400 to 800 mm.
Lev 600: from 500 to 1000 mm.

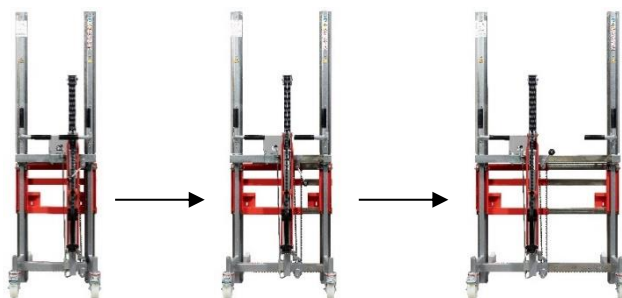

Video demonstration



Technical specifications

References	Capacity (kg)	Version	Lifting stroke (mm)	Lifting speed	Height. HT (mm)	Spacing of longitudinal members (mm)	Front wheels	Rear wheels with brakes	Weight (kg)	Warranty (years)
820 000 0036	300 ⁽¹⁾	Manual	1400	40 or 70 mm/pump	1860	400 to 800	Ø 80 mm nylon bogie	Ø 125 mm nylon	75	10
820 000 0039			1700		2160				78	
820 000 0247			1700 duplex		1910/2160				97	
820 000 0042			2000		2460				81	
820 000 0250			2000 duplex		2110/2460				100	
820 100 0035		Semi-electric	1400	110 to 180 mm/s ⁽³⁾	1860				108	3
820 100 0038			1700		2160				111	
820 100 0246			1700 duplex		1910/2160				120	
820 100 0041			2000		2460				119	
820 100 0249			2000 duplex		2210/2460				138	
820 000 2563	600 ⁽²⁾	Manual	1400	40 or 70 mm/pump	1910	500 to 1000	Ø 80 mm nylon bogie	Ø 125 mm nylon	130	10
820 000 2579			1700		2210				137	
820 000 2584			2000		2510				147	
850 000 0071			2000 duplex		1605/2625				166	
820 100 2850			1400		1910				167	3
820 100 2851		Semi-electric	1700	110 to 180 mm/s ⁽³⁾	2210				173	
820 100 2852			2000		2510				183	
850 100 0141			2000 duplex		1605/2625				201	
850 100 0072			2500 duplex		1850/3150				212	
820 100 3127		Motorized	1500	110 to 180 mm/s ⁽⁴⁾	2010		Ø 80 mm polyurethane bogie ⁽⁵⁾	Ø 125 mm polyuréthane	310	2
820 100 3128			1700		2210				318	
820 100 3129			2000		2510				323	
850 100 0142			2000 duplex		1605/2625				346	
850 100 0143			2500 duplex		1850/3150				360	

⁽¹⁾ Capacity of 300 kg at 350 mm from the masts for models with a maximum lift of 1700 mm and 150 kg for those between 1700 and 2000 mm according to ISO 3691-5

⁽²⁾ Capacity of 600 kg at 500 mm from the masts for models with a maximum lift of 2000 mm and 350 kg for those with a height of more than 2000 mm according to ISO 3691-5

⁽³⁾ 2 x 12 VDC batteries, built-in 24 VDC charger

⁽⁴⁾ Power supply: 24 VDC (2 x 12 VDC batteries), separate 24 VDC charger

⁽⁵⁾ Drive wheel Ø 230 mm polyurethane

Accessories for 300 kg models

Non-exhaustive list of accessories, possibility of custom-made, consult us

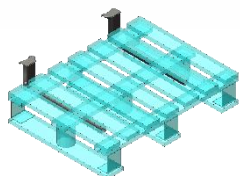

Square tube forks
Useful length: 430 mm.
In 30 mm square tube.

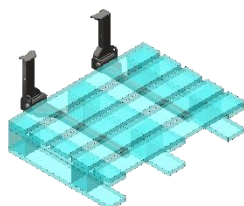

Square folding forks
In 30 mm square tube.



Square inverted forks
In 30 mm square tube.

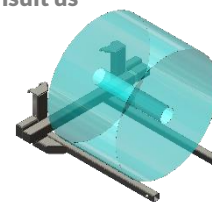

Horizontal coil forks
Internal fork spacing 220 to 650 mm.

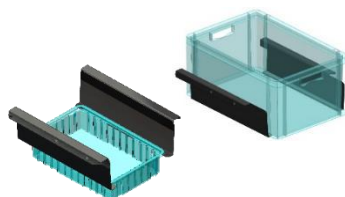

2 position plates
The bin can be picked up from below or from the edge.

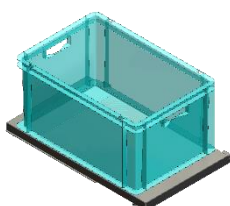

Extendable tray
From 550 to 970 mm.
Tube centre distance: 450 to 870 mm.

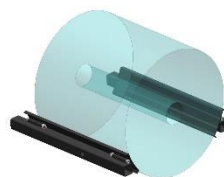

Tiltable sleeves
Allows handling of coils or drums.

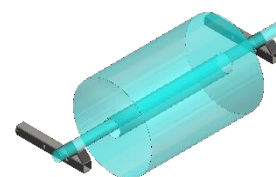

V" coil shaft supports
Allows the handling of a reel positioned on an axis.

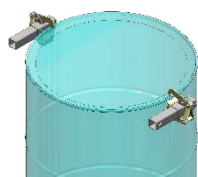

Pair of drum clamps
Allows for the attachment of metal barrels of any diameter thanks to the variable geometry.



Tilting plates
Allows the use of metal or plastic drums with a maximum diameter of 580 mm.

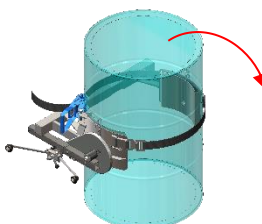

Manual or electric drum
Allows you to empty a barrel

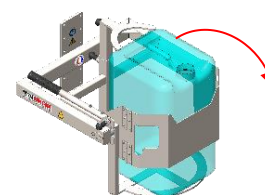

Rotobidon
Allows emptying of a canister.
Capacity 60 kg (20-30 L drums) or 90 kg (60 L drums)

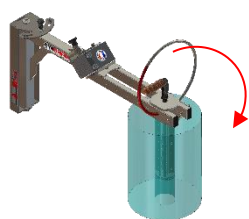

Coil turner with claw
Bore from Ø 70 mm.

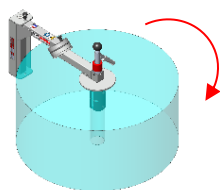

Coil turner
Bore from Ø 70 mm.

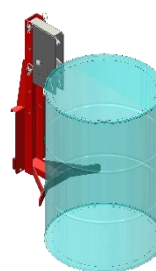

Automatic clamp holder 1 barrel
For metal or plastic drums, with rim, or for plastic drums with lid from 60 to 220 L.



Removable bracket 150 kg

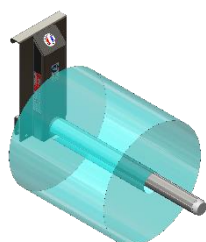

Fixed or folding spur
Bore from Ø 50 mm.

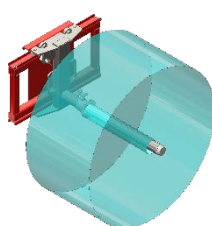

Sideshift spur Bore from Ø 50 mm.

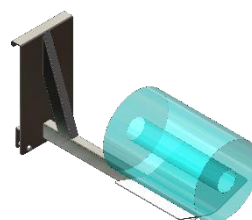

Rectangular spur with V-tray
For reels Ø 600 mm.

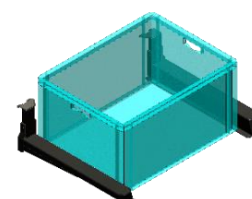

Wrap-around forks
Allows for a floor tray without a lip.

Accessories for 600 kg models

Non-exhaustive list of accessories, possibility of custom-made, consult us

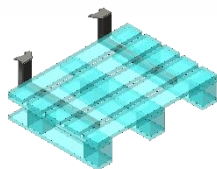

Square tube forks

Useful length: 460 mm.
In 35 mm square tube.

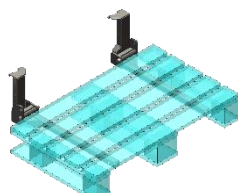

Square folding forks

In 35 mm square tube.

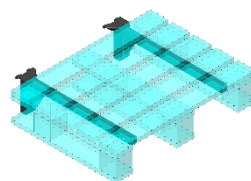

Square inverted forks

In 35 mm square tube.

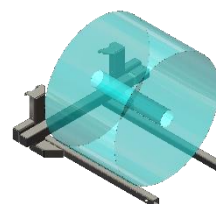

Horizontal coil forks

Internal fork spacing: 310 to 810 mm.

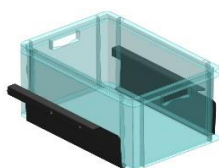

Sliding plates

For bins with or without rim.

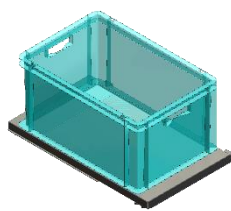

Extendable tray

From 685 to 1200 mm.
Tube centre distance:
580 to 1090 mm.

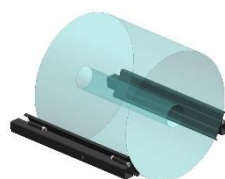

Tiltable sleeves

Allows handling of coils or drums.

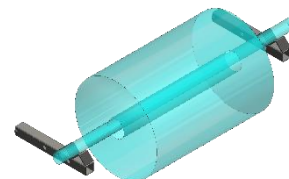

V" coil shaft supports

Allows the handling of a reel positioned on an axis.

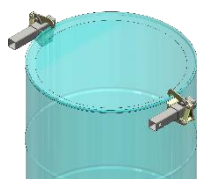

Pair of drum clamps

Allows you to hang a metal barrel of any diameter thanks to the sliding forks.



Tilting plates

Allows the use of metal or plastic drums with a maximum diameter of 580 mm.

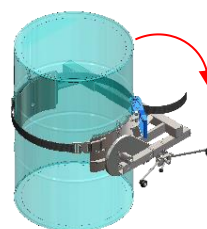

Manual or electric drum

Allows you to empty a barrel

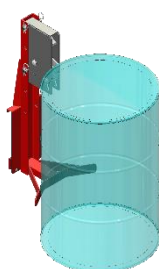

Automatic clamp holder 1 barrel

For metal or plastic drums, with rim, or for plastic drums with lid from 60 to 220 L.

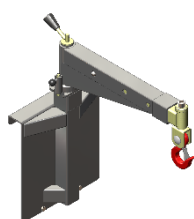

Removable bracket 400 kg

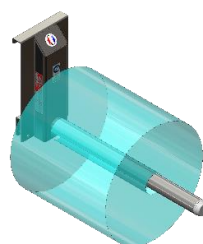

Fixed or folding spur

Bore from Ø 50 mm.

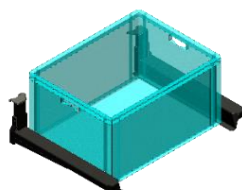

Wrap-around forks

Allows for a floor pan without a lip.

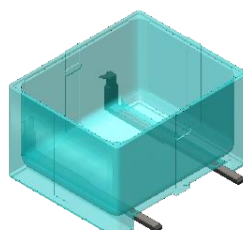

PALVIT type tube forks

Length: 1150 mm.

Options

- ATEX certification.
- Plexiglass allowing a clear view and isolating the operator from moving mechanical parts.
- Surface treatment: anti-corrosion, polyurethane paint, paint and food oil.
- Constant level cell.
- Pneumatic lifting.
- Additional removable batteries that can be transported on a trolley.
- Change of wheel type.